

## Eye Hook Crosby L-320AN

### Product information

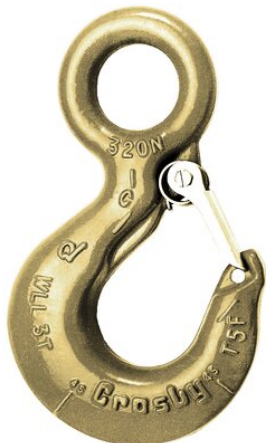

### Features:

- Proper design, careful forging and precision controlled quenched and tempering give maximum strength without excessive weight and bulk.
- Hook extra marked with Deformation Indicators – Two strategically placed marks, one below just the shank or eye and the other on the hook tip, which allows for a QUIC-CHECK™ measurement to determine if the throat opening has changed, thus indicating abuse or overload. To check, use a measuring device to measure the distance between the marks. If the measurement does not meet the dimensions shown below (Deformation Indicator AA), the hook should be inspected further for possible damage.
- Hook extra marked with Angle Indicators – Indicates the maximum included angle which is allowed between two (2) sling legs in the hook.
- Also Available in Carbon steel Grade 4.

... [Read more](#)

**Material:** Alloy steel

**Marking:** According to standard, CE-marked

**Standard:** EN 1677-2

**Warning:** From WLL 31.5 tons up to 60 tons safety factor = 4.5:1

**Safety factor:** 5:1

**Grade:** 8

# Eye Hook Crosby L-320AN

## Blueprint

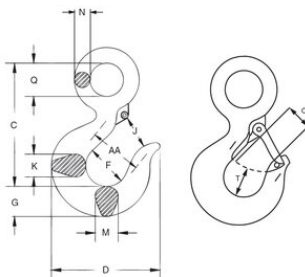

## Technical data

Part code	WLL ton	Weight kg
401300130190	1.25	0.28
401300160190	1.6	0.4
401300250190	2.5	0.65
401300320190	3.2	0.94
401300540190	5.4	1.95
401300800190	8	3.76
401301150190	11.5	6.8
401301600190	16	9.42
401302200190	22	17.9
401303150190	31.5	27.2
401303700190	37	47.6
401304500190	45	67
401306000190	60	103