

## Swivel Jaw / Jaw Crosby S2

### Product information



**Design:** Swivel with jaws equipped with tapered roller thrust bearing.

**Features:**

- Suitable for frequent rotation under load.
- All swivels individually Proof Tested to 2 times the Working Load Limit.
- Pressure lube fitting provided
- All jaws complete with bolts, nuts and cotter pins.
- Other types and capacities up to 1250 t available on demand.

... [Read more](#)

**Marking:** CE-marked

**Note:** Always check before use if your steel wire rope is suitable for use with a swivel.

**Warning:** Not to be used on demolition- (wrecking-) balls!

**Safety factor:** 5:1

## Swivel Jaw / Jaw Crosby S2

### Blueprint

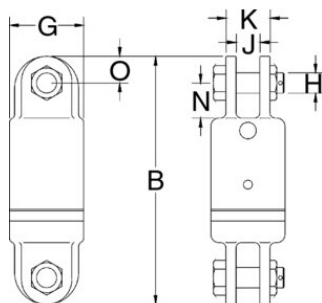

### Technical data

Part code	Rope Ø range mm	WLL ton	Swivel No	B mm	G mm	H mm	J mm	K mm	N mm	O mm	Weight kg
422500300080	13	3	3-S-2	236	70	19.1	22.4	41.1	33.3	25.4	4.37
422500500080	16	5	5-S-2	262	76	22.4	25.4	57	41.1	28.4	6.21
422500850080	19	8.5	8-S-2	321	102	25.4	39.5	71.5	54	35.1	11.9
422501000080	22	10	10-S-2	426	114	38.1	44.5	86	89	44.5	20.8
422501500080	26	15	15-S-2	435	127	38.1	44.5	86	89	44.5	28.5
422502500080		25	25-S-2	527	152	51	51	117	93.5	60.5	64
422503500080		35	35-S-2	527	165	51	51	117	93.5	60.5	70
422504500080		45	45-S-2	641	178	57	63.5	127	102	76	107