

S Hook With Safety Latch On One Side 1750

Product information



High quality S hook equipped with safety latch on one side.

... [Read more](#)

Marking: According to standard, CE-marked, Manufacturer sign, WLL, Date of Production MM/YY

Temperature range: -40°C up to +200°C

Standard: DIN EN 683-2

Safety factor: 4:1

Grade: 8

S Hook With Safety Latch On One Side 1750

Blueprint

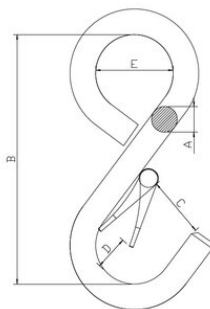

Technical data

Part code	WLL ton	A mm	B mm	C mm	D mm	E mm	Weight kg
420500011970	0.05	8	115	23	12	28	0.08
420500011971	0.1	8	115	23	15	28	0.1
420500021970	0.15	10	115	19	16	28	0.2
420500031970	0.25	12	153	31	23	38	0.36
420500041970	0.35	14	190	42	23	50	0.58
420500051970	0.5	16	230	55	36	63	0.94
420500081970	0.75	20	267	68	41	76	1.8
420500101970	1	22	305	81	50	88	2.3
420500131970	1.3	26	331	91	52	100	3.6
420500151970	1.5	28	380	105	70	115	4.6
420500201970	2	32	407	117	80	127	6.6
420500241970	2.4	36	430	130	80	140	8.9
420500281970	2.8	38	460	140	86	150	11
420500321970	3.2	40	500	149	96	160	13