

S Hook With Safety Latch On One Side 1640

Product information



High quality S hook equipped with safety latch on one side.

... [Read more](#)

Marking: According to standard, CE-marked, Manufacturer sign, WLL, Date of Production MM/YY

Temperature range: -40°C up to +200°C

Standard: DIN EN 683-2

Safety factor: 4:1

Grade: 8

S Hook With Safety Latch On One Side 1640

Blueprint

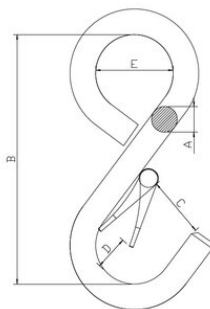

Technical data

Part code	WLL ton	A mm	B mm	C mm	D, mm	E mm	Weight kg
420500011950	0.05	8	80	20	15	28	0.06
420500011951	0.1	8	80	20	15	28	0.08
420500021950	0.2	10	80	17	14	28	0.14
420500031950	0.3	14	100	23	18	35	0.34
420500051950	0.5	16	130	32	22	45	0.56
420500081950	0.75	18	160	42	27	56	0.9
420500101950	1	20	180	48	37	63	1.2
420500131950	1.25	22	200	51	38	70	1.6
420500151950	1.5	26	220	55	50	77	2.4
420500201950	2	32	260	70	56	91	4.4
420500301950	3	36	320	84	65	112	6.5
420500401950	4	40	360	103	76	126	10
420500501950	5	45	400	110	76	140	15