

## Snatch Block H - Hook

---

### Product information



Intended for general lifting purposes. Can also be used for pulling. WLL in table applies for load on head fitting/hook.

**Design:** Snatch block type with covering side plates. Provided with swiveling hook with latch. Bronze bushed sheave in 2-4 tons blocks and roller bearings in larger sizes. Grease fitting in the shaft and cross head.

... [Read more](#)

---

**Material:** Steel.

**Marking:** Type, WLL and wire rope diameter.

**Finish:** Blue painted.

## Snatch Block H - Hook

### Blueprint

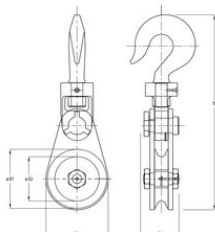

### Technical data

Part code	WLL ton	TA mm	TB mm	TC mm mm	Ø D1 mm mm	Ø D2 mm mm	Weight kg
424100200060	2	82	70	290	75	58	4
424100400060	4	120	70	358	115	90	6
424100400065	4	160	70	432	150	120	14
424100800060	8	210	93	549	200	165	16
424101000060	10	260	115	695	250	205	38
424101200060	12	310	133	797	300	250	56
424101500060	15	210	102	672	200	165	24
424101500066	15	310	133	797	300	250	65
424102200060	22	365	140	960	355	305	90
424103000060	30	310	193	993	300	250	125
424103000067	30	415	155	1,121	405	350	135
424103500060	35	365	193	1,028	350	280	130
424105000060	50	625	275	1,495	600	500	418