

## Fall Protection Anchorage Point SS. PE.SEB

---

### Product information



The Fall Protection Anchorage Point is fitted with an automatic position recovery system for optimum orientation in the direction of the sling.

#### Features:

- 360° rotation.
- Control anti-crack on 100% of product.

... [Read more](#)

---

**Material:** Stainless Steel AISI 316 L

**Marking:** According to standard

**Temperature range:** -20°C up to + 200°C

**Standard:** EN 795

## Fall Protection Anchorage Point SS. PE.SEB

### Blueprint

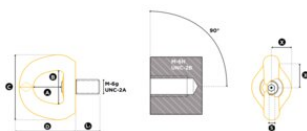

### Technical data

Part code	Max. number of persons	Thread	Torque Nm	A mm	B mm	C mm	D, mm	L1mm mm	S mm	Weight kg
8415SSPESEBM12	1	M 12 (x1.75)	15	38	45	90	80	21	8	0.8
8415SSPESEBM16	1	M 16 (x2)	50	38	45	90	80	27	8	0.82
8415SSPESEBM20	1	M 20 (x2.5)	100	38	45	90	80	30	8	0.84
8415SSPESEBM24	1	M 24 (x3)	150	38	45	90	80	36	8	0.9