

## Master Link Assembly MC1 POWERTEX

### Product information



The POWERTEX Master Link assembly MC1 is part of the range of Powertex G10 Lifting Sling Chain Components. The MC1 assembly is made up of a master link and an integrated connector with a shortening hook. This convenient combination allows operators to easily adjust the assembly length according to the specific application requirements. Due to its integrated components, this part is more cost-efficient, user-friendly, and lightweight than traditional assemblies. The MC-1 is to be used for one leg chain sling assemblies.

Available for 6 mm up to 16 mm chain and from WLL 1,4t up to WLL 10t. All models have a welded master link and forged connector.

Also available as MC2 for two-legged assemblies and MC4 for four-legged assemblies.

#### PowerTex G10 Range benefits:

- 25% higher capacity compared to traditional Grade 8 components
- All POWERTEX G10 components are powder painted in luminous red
- Multi-functional master links and components are included in the range to allow quick and cost-effective assembly of chain slings
- The components meet EN 1677 part 1/2/3/4 +25% WLL
- Each forged component is crack detection tested, and samples are proof load tested.
- Each component is type tested in the factory and fatigue rated to 20,000 cycles at 1.5 times the WLL
- Full traceability through a batch number
- Replacement spare parts available
- All components are chromium 6 free
- POWERTEX 2.2 certificate enclosed with each box of components ... [Read more](#)

**Marking:** According to standard, POWERTEX + Model (MC1-6-10) + traceability code.

**Temperature range:** -40°C up to +200°C without reduction in WLL

**Finish:** Powder painted in luminous red

**Standard:** EN 1677-4 (+25% WLL) , AS 3776

**Note:** All models are welded

**Safety factor:** 4:1

**Grade:** 10

## Master Link Assembly MC1 POWERTEX

### Blueprint

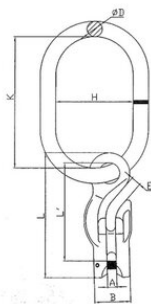

### Technical data

Part code	Code	WLL ton	For chain, 1-leg mm	A mm	B mm	D mm	E mm	H mm	K mm	L mm	L' mm	Weight kg
402100140790	MC1-6-10	1.4	6	8	32	13	8	60	110	112	88	1.24
402100250790	MC1-8-10	2.5	8	10	36	14	10	70	120	145	116	1.81
402100400790	MC1-10-10	4	10	12.5	48	17	12.5	80	140	184	145	3.41
402100670790	MC1-13-10	6.7	13	15.5	59.5	22	15.5	95	160	223	178	6.2
402101000790	MC1-16-10	10	16	19	70	25	19	110	190	273	216	11.25