

## Open Wedge Socket Tailgrip OWS-TG with Pin

### Product information



The tailgrip open wedge socket with pin is a fast detachable socket. It is suitable for usage in a sub-zero temperature environment

Basket and wedge in quenched and tempered cast steel. Wedge and basket are designed for easy installation and optimal wire rope efficiency and with the added benefit to terminate the tail to the wedge itself.

... [Read more](#)

**Material:** Quenched and tempered cast steel

**Marking:** According to standard, CE-marked, All parts are fully traceable to their certificate by batch or serial number marked on each component.

**Temperature range:** - 40°C to + 110°C - Use at higher temperatures possible with reduction of WLL.

**Finish:** Blue painting or hot dipped galvanized

**Standard:** EN 10204

**Warning:** The efficiency of a 6 and 8 strand wire rope/wedge socket connection is 80% of the minimum breaking load of the wire but limited to the minimum breaking load of the socket (MBL).

## Open Wedge Socket Tailgrip OWS-TG with Pin

### Blueprint

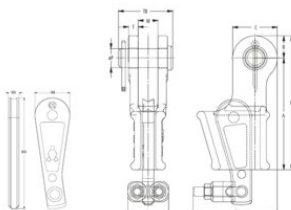

### Technical data

Part code	Rope Ø range mm	MBL ton	Finish	A mm	B mm	C mm	E mm	øP mm	T mm	TH mm	TL mm	TB mm	W mm	WH mm	WB mm	WD mm	Weight kg
121501000225	9-10	12	Painted	145	23	46	40	21	11	76	168	63	21	130	36	12	1.9
121501300225	11-13	20	Painted	157	29	57	55	25	12	100	185	67	25	170	48	14	2.4
121501600225	14-16	25	Painted	190	35	70	64	30	15	125	225	85	31	195	57	18	5
121501900225	18-19	40	Painted	210	40	80	68	35	16	142	250	95	38	222	70	21	8
121502200225	20-22	55	Painted	252	48	95	74	41	18	164	300	110	44	251	77	24	11
121502600225	23-26	75	Painted	298	55	110	84	51	22	189	353	128	51	274	83	28	16
121502900225	27-29	90	Painted	322	65	130	95	57	25	217	387	142	57	292	91	30	23
121503200225	30-32	100	Painted	350	73	146	105	63	28	238	423	155	63	349	108	33	34