

Lever Hoist KITO LB Series

Product information



The KITO LB leverhoist is built with premium grade components and makes it particularly suitable for continuous operation under most severe conditions.

Features:

- Standard supplied with a unique freewheel chain adjusting mechanism with overload protection.
- Rugged and ergonomic lever handle.
- Smooth geared mechanism for effortless handling.
- Robust mechanical load brake increases the safety of the operator.
- Double-reduction gearing requires minimum manual power for operation at full load.
- Open load sheave allows easy inspection and cleaning without dismantling the unit.
- Sealed gears and brake are protected against damage from dust and water.
- Fourfold riveted and forged carbon steel bottom hook.
- Abrasion-resistant nickel-plated load chain V(G100) for high and uniform strength (1000 N/mm²), in accordance with standard DIN EN 818-7.

Optional:

- Friction clutch
- Overload signal
- Wire rope clip
- Shipyard hooks
- Without freewheel mechanism

... [Read more](#)

Material: High grade Steel housing, nickel-plated load chain, Carbon steel hooks

Marking: According to standard, CE-marked

Standard: EN 13157

Warning: Minimum load is needed for the load pressure brake to work correct.

Safety factor: 4:1

Lever Hoist KITO LB Series

Blueprint

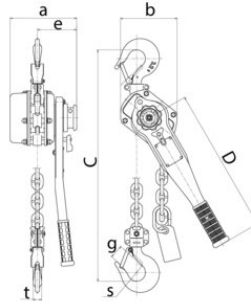

Technical data

Part code	Code	WLL ton	Lifting height m	Number of falls	Min. load kg	Load chain mm	A mm	B mm	C mm	D mm	e mm	mm	g mm	mm	S mm	t mm	Weight kg
500500080150037	LB008S015	0.8	1.5	1	25	5.6 x 15.7	114	119	280	245	97	23.5	32.5	14	5.7		
500500080200030	LB008S020	0.8	2	1	25	5.6 x 15.7	114	119	280	245	97	23.5	32.5	14	6.05		
500500080300030	LB008S030	0.8	3	1	25	5.6 x 15.7	114	119	280	245	97	23.5	32.5	14	6.8		
500500081050030	LB008S105	0.8	10.5	1	25	5.6 x 15.7	114	119	280	245	97	23.5	32.5	14	12		
500500100150030	LB010S015	1	1.5	1	25	5.6 x 15.7	114	119	300	245	97	29	42.5	15	5.9		
500500100200030	LB010S020	1	2	1	25	5.6 x 15.7	114	119	300	245	97	29	42.5	15	6.25		
500500100300034	LB010S030	1	3	1	25	5.6 x 15.7	114	119	300	245	97	29	42.5	15	7		
500500100500030	LB010S050	1	5	1	25	5.6 x 15.7	114	119	300	245	97	29	42.5	15	8.35		
500500160150035	LB016S015	1.6	1.5	1	38	7.1 x 19.9	159	126	335	265	100	32	42.5	19	8		
500500160200030	LB016S020	1.6	2	1	38	7.1 x 19.9	159	126	335	265	100	32	42.5	19	8.55		
500500160300034	LB016S030	1.6	3	1	38	7.1 x 19.9	159	126	335	265	100	32	42.5	19	9.7		
500500250150034	LB025S015	2.5	1.5	1	54	8.8 x 24.6	173	150	375	265	102	36.5	47	21	11.2		
500500250300030	LB025S030	2.5	3	1	54	8.8 x 24.6	173	150	375	265	102	36.5	47	21	13.8		
500500320150030	LB032S015	3.2	1.5	1	35	10.0 x 28.0	190	159	395	415	112	39	50	24.5	15		
500500320250030	LB032S025	3.2	2.5	1	35	10.0 x 28.0	190	159	395	415	112	39	50	24.5	17.3		
500500320300034	LB032S030	3.2	3	1	35	10.0 x 28.0	190	159	395	415	112	39	50	24.5	18.5		
500500321000030	LB032S100	3.2	10	1	35	10.0 x 28.0	190	159	395	415	112	39	50	24.5	34.55		
500500630150030	LB063S015	6.3	1.5	2	90	10.0 x 28.0	190	217	540	415	112	50	60	34	26		
500500630300034	LB063S030	6.3	3	2	90	10.0 x 28.0	190	217	540	415	112	50	60	34	33.1		
500500900150030	LB090S015	9	1.5	3	130	10.0 x 28.0	190	304	680	415	112	72.5	85	41.5	40		
500500900300030	LB090S030	9	3	3	130	10.0 x 28.0	190	304	680	415	112	72.5	85	41.5	50.5		
500500900350030	LB090S035	9	3.5	3	130	10.0 x 28.0	190	304	680	415	112	72.5	85	41.5	54		

Lever Hoist KITO LB Series
