

Welding Ring ASHI

Product information

Welding must be carried out according to EN ISO 5817 resp. 15 429 by a qualified welder according to EN 287-1 standard.

Approved according to Machinery directive 2006/42/EC.

... [Read more](#)



Material: Stainless steel AISI 316

Marking: CE-marked, WLL, Supplier

Safety factor: 5:1

Welding Ring ASHI

Blueprint

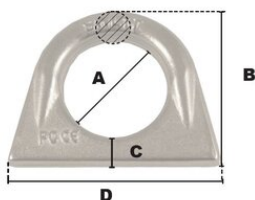

Technical data

Part code	Diameter mm	WLL ton	A mm	B mm	C mm	D mm	Weight kg/100pc
421100020680	9	0.2	24	43	10	54	6
421100050680	12	0.5	31	55	12	68	14.5
421100100680	13	1	43	67	12	85	18